

a hastings street new massing model

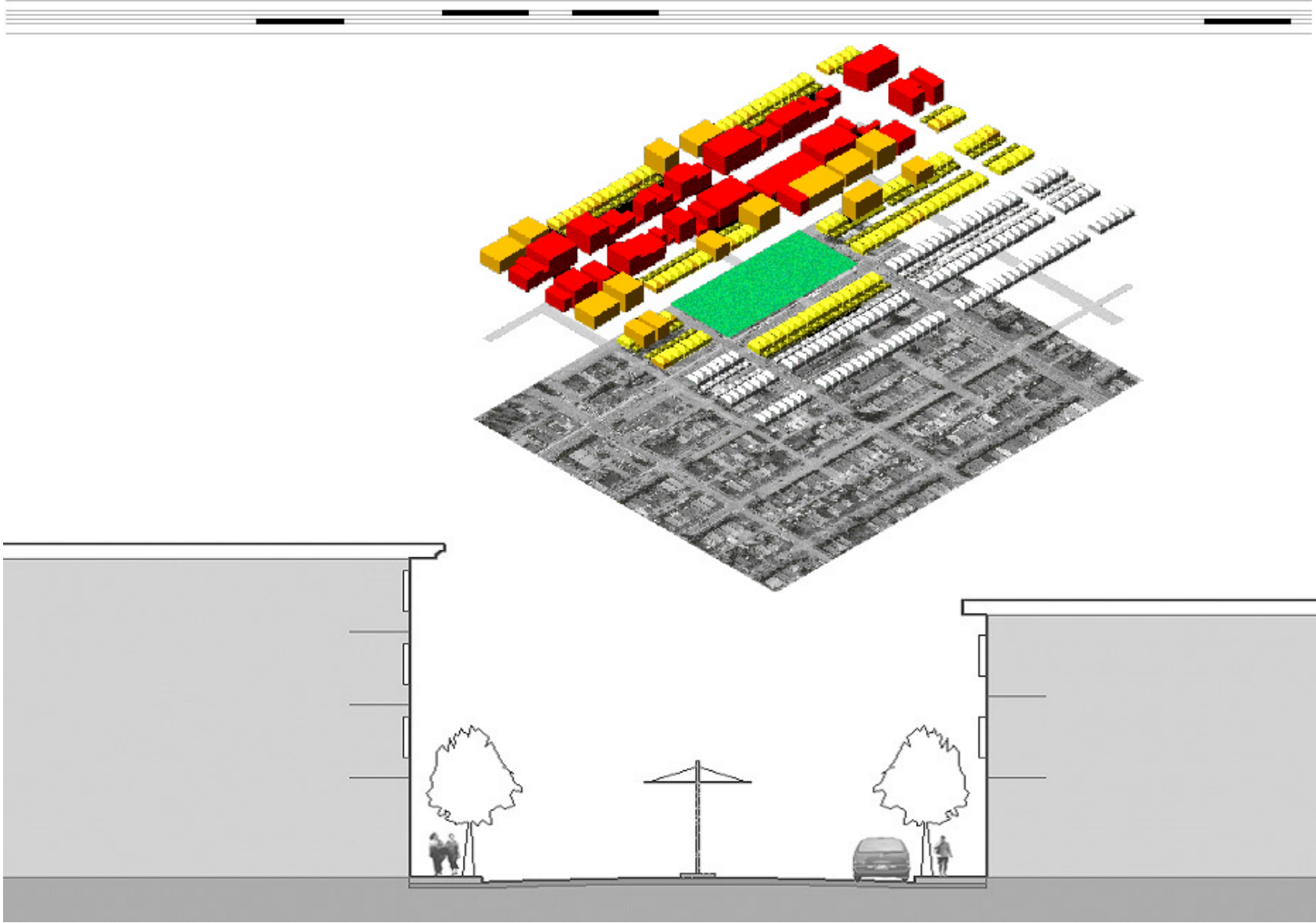

a hastings street current zoning comparison

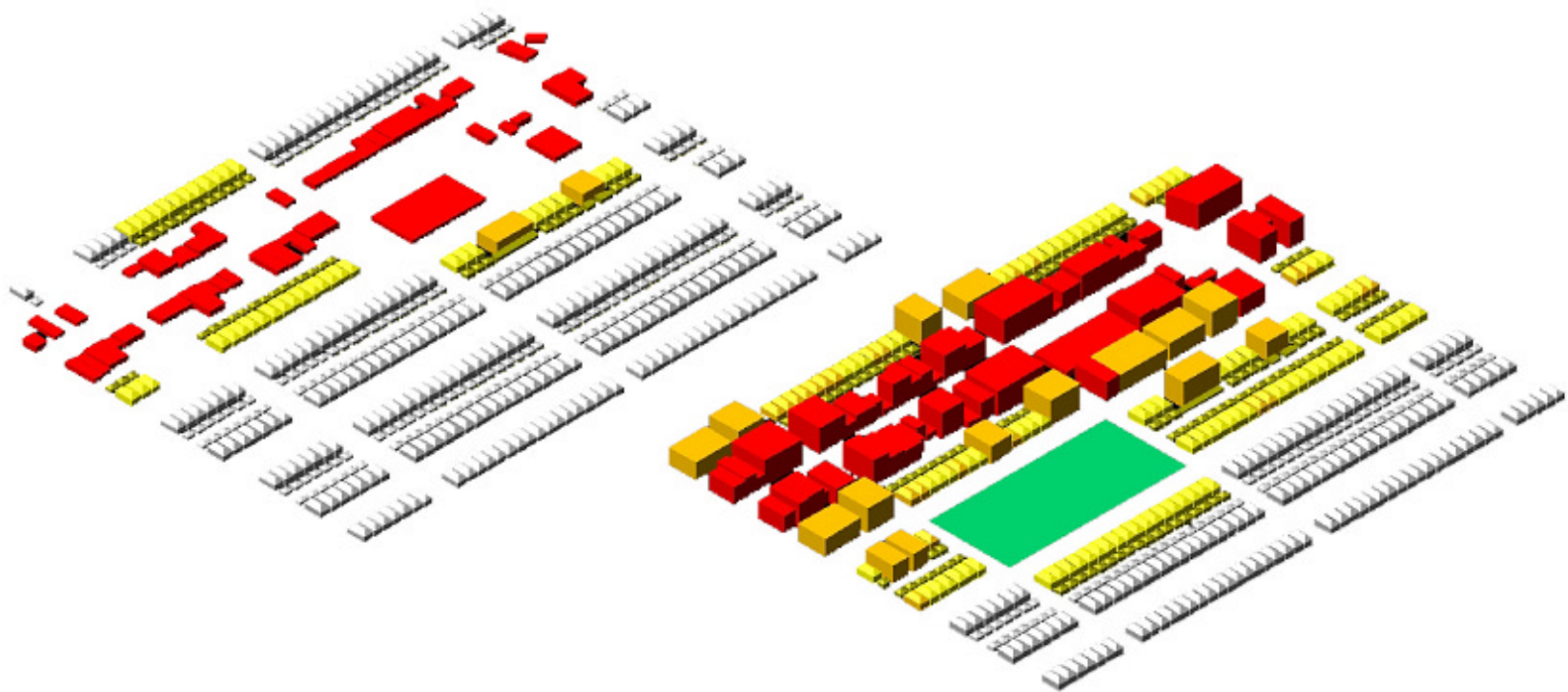

public infrastructure has a ripple effect. Its effects are felt from parallel to the infrastructure. From installing a trolley on Hastings Street, the effects are first seen in the increase in commercial, mixed and comprehensive development on Hastings Street. The adjacent two streets then see an increase in mixed and multi-residential development. Two streets from Hastings we start to see more single residential housing with some multi-housing. A good public street life also requires good public parks that are less than a two-minute walking distance from your house. Burnaby has a lot of park area but it is all situated in one place, a ten minute drive from most houses.

